

## Working-/ Repair Instructions

Replace the cover

Sport, Cross, Cab, Lite

Document no : -

Revision: 1

Released: 04/01/2019

Estimated repair time 20min

# Replace the cover for Sport, Cross, Cab, Lite



- Crosshead screwdriver



1. Open the cover on both sides



2. Open the screw which fixes the cover on the inside of the trailer

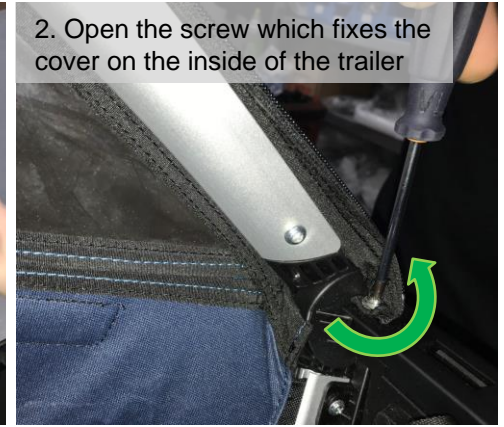

3. Open the same screw on the other side

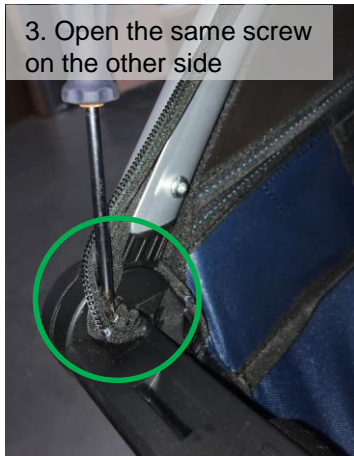

4. Remove the plastic clamps on the backside of the cover

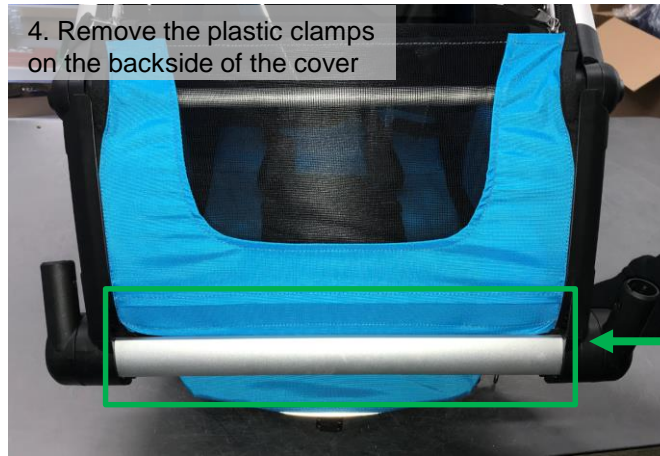

# Replace the cover for Sport, Cross, Cab, Lite

5. Remove the plastic clamps on the backside of the cover and pull out the cover from it's guiding profile



# Replace the cover for Sport, Cross, Cab, Lite

6. Put the new cover at first on the front side in the guiding profiles on both sides



7. Put then the backside of the cover on both sides in the guiding profiles

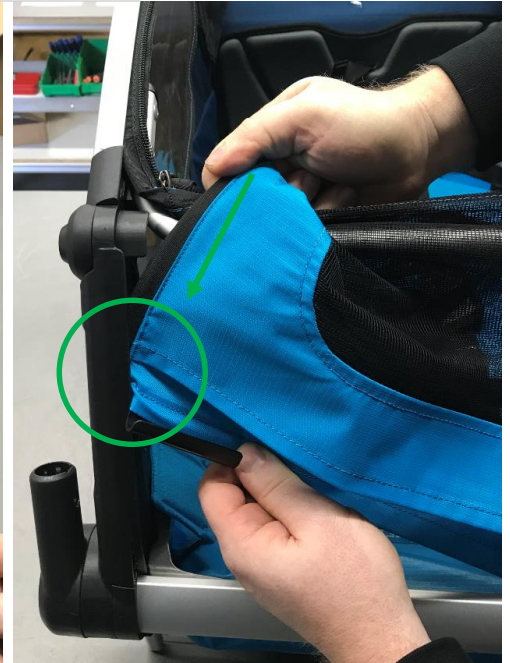

# Replace the cover for Sport, Cross, Cab, Lite

8. Put the second side of the cover in the guiding profiles



9. Grab in the inner side and mount back the plastic clamps in the provided mountings



# Replace the cover for Sport, Cross, Cab, Lite

10. Grab in the inner side and mount back the second plastic clamp in the provided mounting



11. Put in the screws which fixes the cover in the front on both sides



10. Close the zippers and check if all functions working perfectly – Ready!



**Thule Group**»

ACTIVE LIFE, SIMPLIFIED.